

LOCUST HILL Condos

| Parcel No. | Unit No. | Condo Owner |
|--------------|-----------|-----------------------|
| 20-50-12.001 | UNIT G-1 | Kanard |
| 20-50-12.002 | UNIT G-2 | Ringer |
| 20-50-12.003 | UNIT G-3 | Friedman |
| 20-50-12.004 | UNIT G-4 | Szczerbak |
| 20-50-12.005 | UNIT G-5 | Heigartner/Mitrani |
| 20-50-12.006 | UNIT G-6 | Rebeor |
| 20-50-12.007 | UNIT G-7 | Quelch |
| 20-50-12.008 | UNIT G-8 | LaBombard |
| 20-50-12.009 | UNIT F-9 | Leopold |
| 20-50-12.010 | UNIT F-10 | Bovaird |
| 20-50-12.011 | UNIT F-11 | Young |
| 20-50-12.012 | UNIT F-12 | Raymond / Jasinski |
| 20-50-12.013 | UNIT F-13 | Gorman |
| 20-50-12.014 | UNIT F-14 | Kline/McCorkel |
| 20-50-12.015 | UNIT F-15 | Lenentine |
| 20-50-12.016 | UNIT F-16 | Donahue |
| 20-50-12.017 | UNIT E-17 | Blaisdell |
| 20-50-12.018 | UNIT E-18 | Mernick |
| 20-50-12.019 | UNIT E-19 | Russell / Baker |
| 20-50-12.020 | UNIT E-20 | Piper |
| 20-50-12.021 | UNIT E-21 | Berry |
| 20-50-12.022 | UNIT E-22 | Pinney |
| 20-50-12.023 | UNIT E-23 | Sheridan-Orr |
| 20-50-12.024 | UNIT E-24 | Emple |
| 20-50-12.025 | UNIT E-25 | McCorkel |
| 20-50-12.026 | UNIT E-26 | Paskevich |
| 20-50-12.027 | UNIT E-27 | Pepper |
| 20-50-12.028 | UNIT E-28 | Stonim |
| 20-50-12.029 | UNIT E-29 | Miller |
| 20-50-12.030 | UNIT E-30 | Gilca |
| 20-50-12.031 | UNIT D-31 | Rudy |
| 20-50-12.032 | UNIT D-32 | Bailey |
| 20-50-12.033 | UNIT D-33 | Locust Lakeview Prop. |
| 20-50-12.034 | UNIT D-34 | Pepper |
| 20-50-12.035 | UNIT D-35 | Nina Properties LLC |
| 20-50-12.036 | UNIT D-36 | Wheeler |
| 20-50-12.037 | UNIT D-37 | Sandage |
| 20-50-12.038 | UNIT D-38 | Pepper |
| 20-50-12.039 | UNIT D-39 | Harvey/Holden |
| 20-50-12.040 | UNIT C-40 | Cianci |
| 20-50-12.041 | UNIT C-41 | Gude |
| 20-50-12.042 | UNIT C-42 | Cardenas / Milagros |
| 20-50-12.043 | UNIT C-43 | Gonda |
| 20-50-12.044 | UNIT C-44 | Wetherbee |
| 20-50-12.045 | UNIT C-45 | Bates |
| 20-50-12.046 | UNIT C-46 | Rutkowski |
| 20-50-12.047 | UNIT C-47 | Bodarev |
| 20-50-12.048 | UNIT C-48 | Nistor |
| 20-50-12.049 | UNIT C-49 | Haug |
| 20-50-12.050 | UNIT C-50 | Long/Martil |
| 20-50-12.051 | UNIT C-51 | Thibault / Boulet |
| 20-50-12.052 | UNIT C-52 | Lovelette |
| 20-50-12.053 | UNIT C-53 | Solomon |
| 20-50-12.054 | UNIT B-54 | Adams |
| 20-50-12.055 | UNIT B-55 | Schmidt |
| 20-50-12.056 | UNIT B-56 | Grenier |
| 20-50-12.057 | UNIT B-57 | Damon |
| 20-50-12.058 | UNIT B-58 | MacGregor / Collamer |
| 20-50-12.059 | UNIT B-59 | Nina Prop LLC |
| 20-50-12.060 | UNIT B-60 | Senesac |
| 20-50-12.061 | UNIT B-61 | Duffy |
| 20-50-12.062 | UNIT B-62 | Almena-Aliste |
| 20-50-12.063 | UNIT B-63 | Levins |
| 20-50-12.064 | UNIT B-64 | Rolla |
| 20-50-12.065 | UNIT B-65 | Leja |
| 20-50-12.066 | UNIT B-66 | Laird |
| 20-50-12.067 | UNIT B-67 | Raabe / Diaby |
| 20-50-12.068 | UNIT A-68 | Stevens |
| 20-50-12.069 | UNIT A-69 | Brooks |
| 20-50-12.070 | UNIT A-70 | Marvin |
| 20-50-12.071 | UNIT A-71 | Willis/Russell |
| 20-50-12.072 | UNIT A-72 | Sweeney |
| 20-50-12.073 | UNIT A-73 | Chaput |
| 20-50-12.074 | UNIT A-74 | McDonald/Perez |
| 20-50-12.075 | UNIT A-75 | Macrae |

20-50-12
27.48 AS

Locust Hill Development Inc.

MARTINDALE WEST Condos

| Parcel No. | Unit No. | Condo Owner |
|--------------|-----------|-----------------------|
| 20-50-17.001 | UNIT A-1 | Moureau |
| 20-50-17.002 | UNIT A-2 | Chen / Xia |
| 20-50-17.003 | UNIT A-3 | Mahar |
| 20-50-17.004 | UNIT A-4 | Shlitz |
| 20-50-17.005 | UNIT B-5 | Putnam / Steinmiller |
| 20-50-17.006 | UNIT B-6 | May |
| 20-50-17.007 | UNIT B-7 | Matheson / Westfall |
| 20-50-17.008 | UNIT B-8 | Bernick / Brochu |
| 20-50-17.009 | UNIT C-9 | Codding |
| 20-50-17.010 | UNIT C-10 | Yahi |
| 20-50-17.011 | UNIT C-11 | Rosenstein |
| 20-50-17.012 | UNIT C-12 | Ruby Basha Properties |
| 20-50-17.013 | UNIT D-13 | Sears |
| 20-50-17.014 | UNIT D-14 | Spagnolo |
| 20-50-17.015 | UNIT D-15 | Gasser |
| 20-50-17.016 | UNIT D-16 | Miller |
| 20-50-17.017 | UNIT E-17 | 147 Loomis Street LLC |
| 20-50-17.018 | UNIT E-18 | Brownell |
| 20-50-17.019 | UNIT E-19 | Carter |
| 20-50-17.020 | UNIT E-20 | Kupiec |
| 20-50-17.021 | UNIT F-21 | Ouimet |
| 20-50-17.022 | UNIT F-22 | Murphy |
| 20-50-17.023 | UNIT F-23 | Roden |
| 20-50-17.024 | UNIT F-24 | Xia / Chen |
| 20-50-17.025 | UNIT G-25 | Gerrard |
| 20-50-17.026 | UNIT G-26 | Leonard |
| 20-50-17.027 | UNIT G-27 | Barrett |
| 20-50-17.028 | UNIT G-28 | 219 Martindale Rd LLC |
| 20-50-17.029 | UNIT H-29 | Basha |
| 20-50-17.030 | UNIT H-30 | 243 Martindale LLC |
| 20-50-17.031 | UNIT H-31 | Klimas |
| 20-50-17.032 | UNIT H-32 | Frimpong |

Martell
20-50-17
5.8 AS

SEE MAP
20

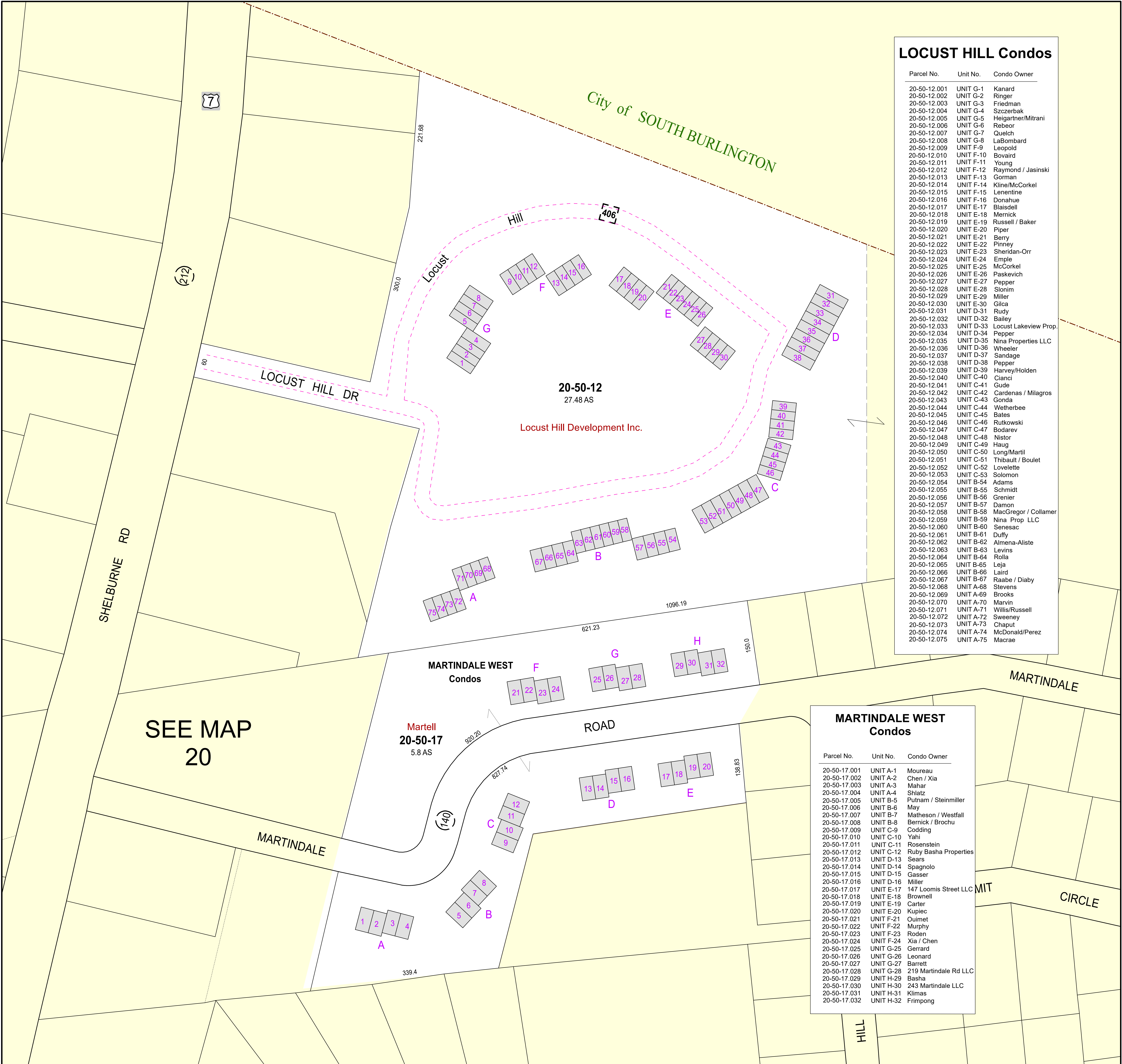

THIS MAP IS FOR ASSESSMENT PURPOSES. IT IS NOT VALID FOR LEGAL DESCRIPTION OR CONVEYANCE.
THE HORIZONTAL DATUM IS THE VERMONT STATE PLANE COORDINATE SYSTEM, NAD 83.

REVISED & REPRINTED BY
CAI Technologies
Precision Mapping, Geospatial Solutions
11 PLEASANT STREET, LITTLETON, NH 03561
800.322.4540 - WWW.CAI-TECH.COM

LEGEND

| | | | | | | | |
|---------------------|------------|-------------------|-----------|--------------------------|-----------|---------------|---|
| Parcel Number | 20-50-23.1 | Match Line | — — | River as a Property Line | — — — | Open Space | □ |
| Deed Acres | 100 A | Property Line | — | River thru Parcel | — — — — | Nat. Conserv. | □ |
| Computed Acres | 100.5 AC | Deed Line | — | Private R.O.W. | — — — — — | Town Owned | □ |
| Surveyed Acres | 100.25 AS | Rainroad Boundary | — — — — — | | | | |
| Subdivision Lot No. | 100(5) | Veeco Easement | — — — — — | | | | |
| Scaled Dimensions | 500(s) | Town Line | — — — — — | | | | |
| Deed/Survey Dim. | 450.15 | | | | | | |
| Vermont Route | 7 | | | | | | |
| Town Rd Number | (100) | | | | | | |
| Subdivision Lot No. | 100(5) | | | | | | |
| Building | □ | | | | | | |
| Approx. Location | □ | | | | | | |

FEET 0 25 50 100 150
METERS 0 10 20 30
REVISED TO: APRIL 1, 2023

PROPERTY MAPS
SHELBURNE
VERMONT

INDEX DIAGRAM
Map showing the location of the current map within the larger context of Shelburne, Vermont.

MAP NO.
16